

**LIGHT AND POWER**

SERVICE ENTRANCE CABLE TYPE UF, IS BURIED AT LEAST TWO FEET, LOOPED AND BROUGHT THROUGH WALL IN CONDUIT. PLUG CONDUIT WITH HYDRAULIC CEMENT.

SERVICE PANEL IS FUSED SAFETY SWITCH FOR TWO 20 AMPERE 120 VOLT CIRCUITS.

OUTLETS ARE SURFACE MOUNTED NON-METALLIC GROUNDING TYPE. CIRCUIT WIRING IS N<sub>e</sub> 12 UF.

SUGGESTED ELECTRICAL EQUIPMENT:

- TWO BURNER HOT PLATE.
- 1600 WATT RESISTANCE HEATER WITH FAN.
- DEHUMIDIFIER (IN HUMID CLIMATES)

PROVIDE BATTERY OPERATED LANTERNS AND FLASHLIGHTS FOR USE IN CASE OF POWER FAILURE.

**PLAN ABOVE GROUND**  
(ANTENNA BLOCK NOT SHOWN)

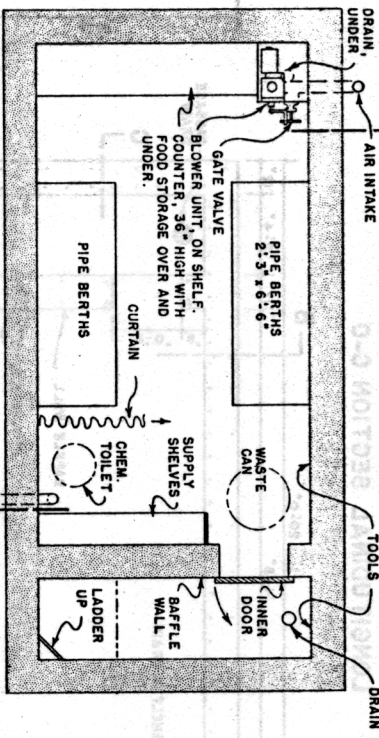
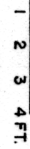

**ARRANGEMENT PLAN**

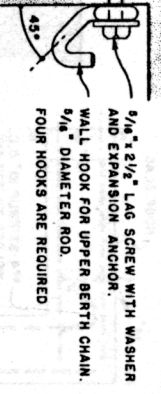
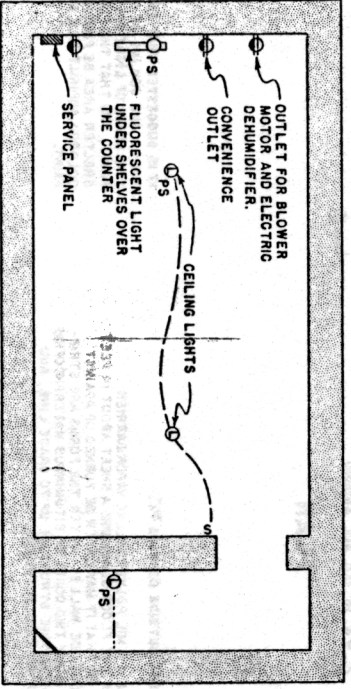

**BERTH SUPPORTS**

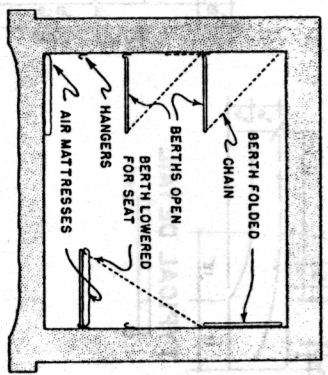
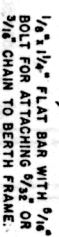

**TYPICAL CROSS SECTION**

SHOWING ARRANGEMENT OF BERTHS

BERTHS ARE RECTANGULAR FRAMES OF 1" STD. PIPE WITH PLAIN ELBOWS, DOWEL AND PIN ONE END RAIL, OR USE LONG SCREW WITH CLOSE NIPPLE AND COLLAR FOR ASSEMBLY. COVER WITH 1/4" x 1" WELDED WIRE FABRIC, WITH TRANSVERSE WIRES SPACED 1/2".