

POLE BRACING DETAIL

12" 6" 0" 1' 2" SCALE

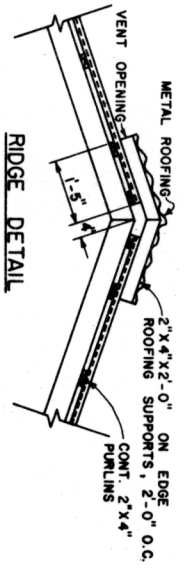

RIDGE DETAIL

12" 6" 0" 1' 2" SCALE

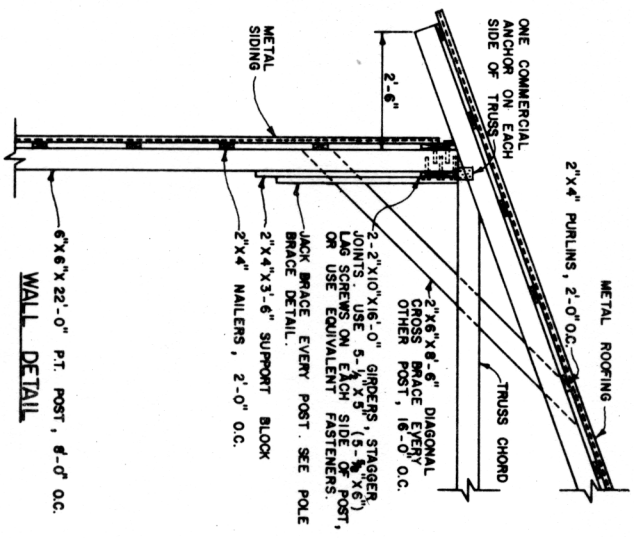

WALL DETAIL

12" 6" 0" 1' 2" SCALE

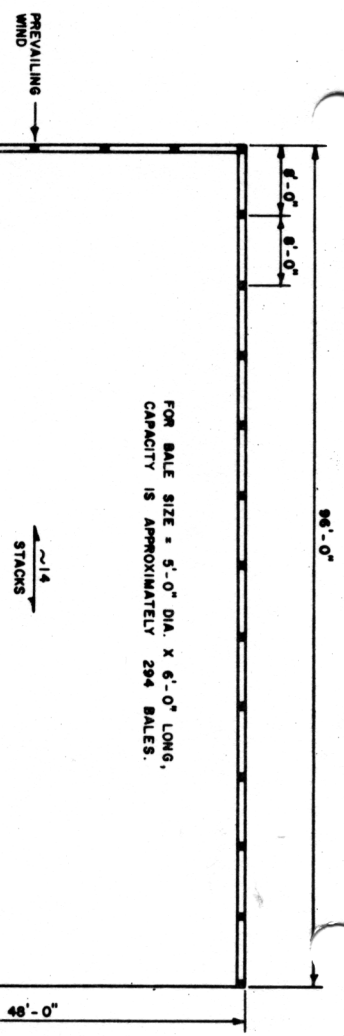

PLAN

12" 6" 0" 1' 2" SCALE

FOR BALE SIZE = 5'-0" DIA. x 6'-0" LONG, CAPACITY IS APPROXIMATELY 284 BALES.

NOTES:

1. P.T. = PRESSURE TREATED. TREAT TO A PRESERVATION RETENTION OF 5-7 POUNDS PER CUBIC FOOT AS PER A.W.P.A. STANDARDS.
2. BALES WILL SETTLE AND SPREAD. ALLOW 4'-5" ON ALL SIDES OF EACH BALE WHEN PLANNING STORAGE.
3. SELECT TRUSS THAT SUPPORTS SNOW AND WIND LOADS FOR YOUR AREA. DESIGN SPACE TRUSSES 4' O.C. (2' O.C.) DESIGN SHOWN IS FOR WINDS 20 LBS. PER SQ. FT. REQUIREMENTS FOR A 30 LBS. PER SQ. FT. SNOW LOAD.

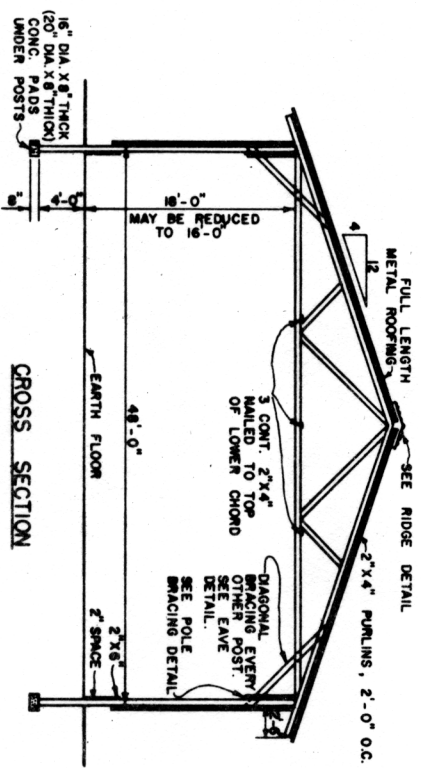

CROSS SECTION

12" 6" 0" 1' 2" SCALE

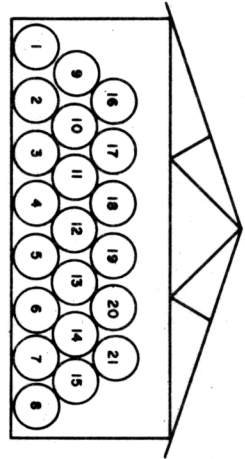

STACKING DIAGRAM (21 BALES, 5' DIAMETER)

12" 6" 0" 1' 2" SCALE

COOPERATIVE EXTENSION WORK IN AGRICULTURE AND HOME ECONOMICS

UNITED STATES DEPARTMENT OF AGRICULTURE COOPERATING

WY STORAGE FOR LARGE ROUND BALES TN '80 EX 6350 SHEET 1 OF 1