

NOTE:
FANS SPACED 30'-0" O.C. AND CAPABLE
OF DELIVERING 10,000 CFM EACH AT
1/2" S.P. MAX. VENTILATION RATE -
6 CFM PER SQU. FT. PER FOOT
OF HOUSE LENGTH.

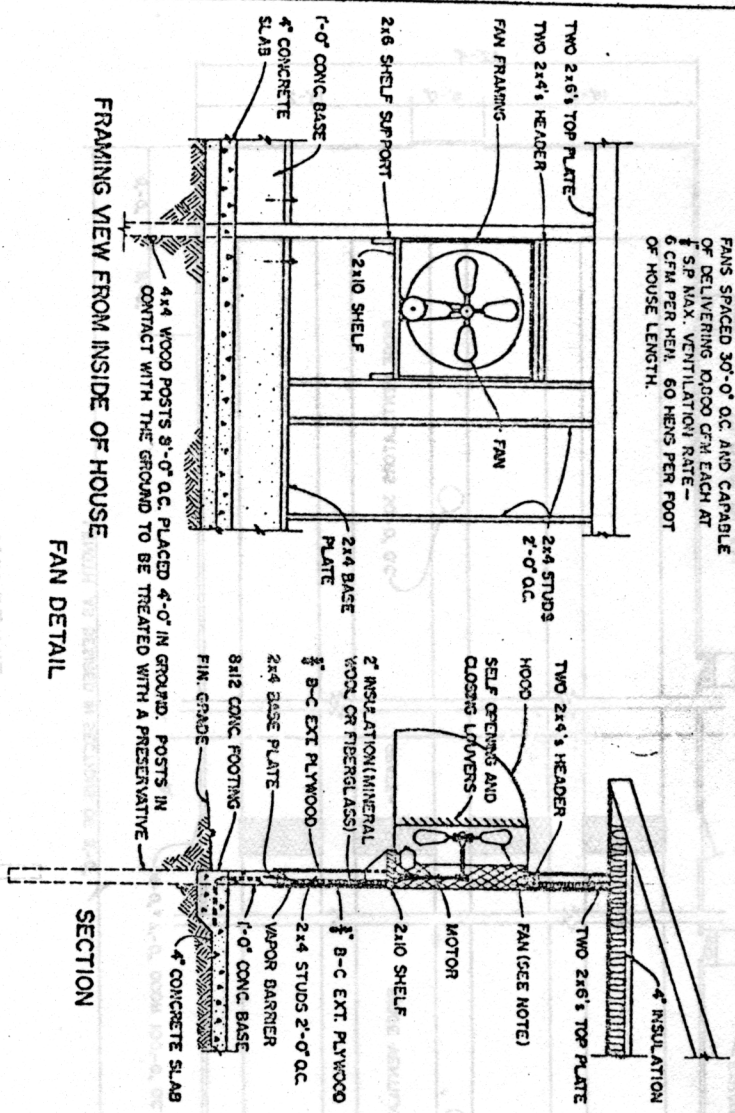

FRAMING VIEW FROM INSIDE OF HOUSE

FAN DETAIL

SECTION

PERSPECTIVE

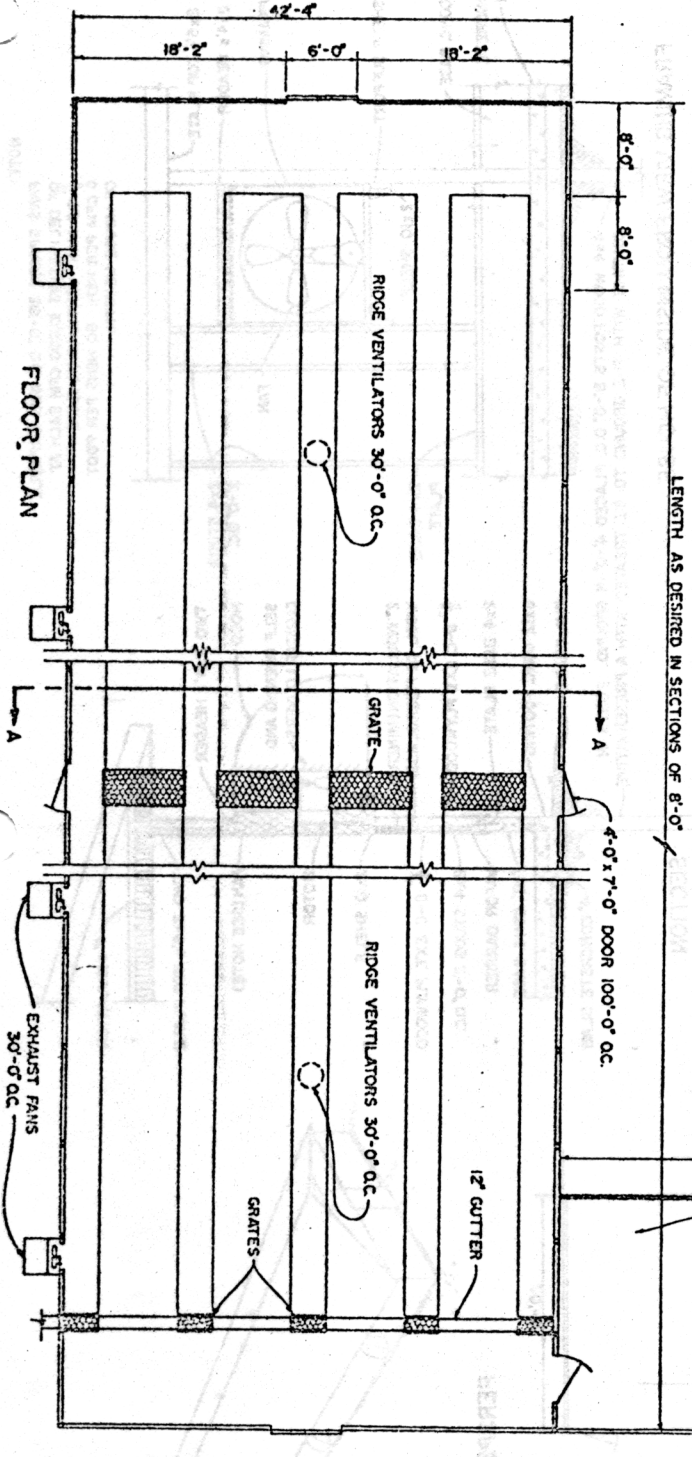
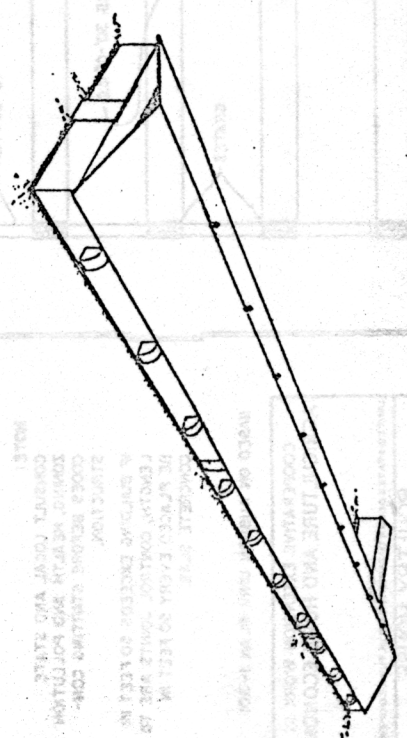

LENGTH AS DESIGNED IN SECTIONS OF 8'-0"

MENTION OF A TRADE NAME DOES NOT
CONSTITUTE A GUARANTEE OR WARRANTY
OF THE PRODUCT BY THE U.S.
DEPARTMENT OF AGRICULTURE OR ANY
OTHER PRODUCTS NOT MENTIONED.

NOTE:
CONSULT LOCAL AND STATE
ZONING, HEALTH AND POLLUTION
CODES BEFORE STARTING CON-
STRUCTION.
IF BUILDING EXCEEDS 50 FEET IN
LENGTH, CONTROL JOINTS ARE TO
BE PLACED EVERY 50 FEET IN
CONCRETE SLAB.

BASED ON AUBURN UNIV. PLAN I-301

COOPERATIVE EXTENSION WORK IN
AGRICULTURE AND HOME ECONOMICS

UNITED STATES DEPARTMENT OF AGRICULTURE
POULTRY HOUSE
CAGED LAYERS

ALA. 72 EX. 174 SHEET 1 OF 2