

MATERIAL FOR ONE ROOF TRUSS

Roofers	1 - 1x6-2x12
Ties	1 - 1x6-2x12
Inner braces	2 - 2x4x12
Outer braces	1 - 2x4x12
Vertical struts	1 - 2x4x12
Gussets	5 square 20x21 8 - plywood
Nails	6d, 2.9 lbs

NOTE: Nailing shown is required for gussets on each face of truss

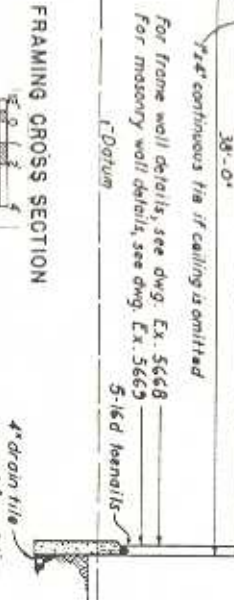
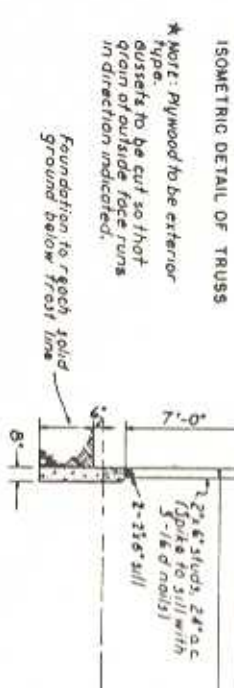
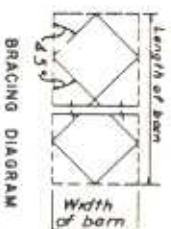

COOPERATIVE EXTENSION WORK IN AGRICULTURE AND HOME ECONOMICS

UNITED STATES DEPARTMENT OF AGRICULTURE COOPERATING

GABLE ROOF BARN FRAMING

38 FOOT WIDTH

USDA '48 Ex. 5668 SHEET 1 OF 1

*NOTE: Plywood to be exterior type, gussets to be cut so that grain of outside face runs in direction indicated.