

SUGGESTED CEILING SECTIONS

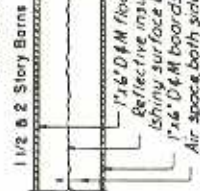

Cold areas of ZONE 1 (Large or small barns)



Average areas of ZONE 1 (Large or small barns)



Warm areas of ZONE 1 (Large or small barns)



Average areas of ZONE 2 (Large or small barns)

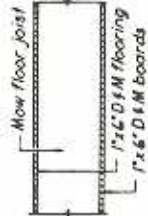

Warm areas of ZONE 2 (Large or small barns)



Warm areas of ZONE 2 (Large or small barns)

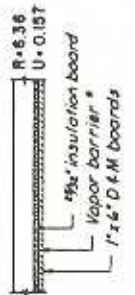
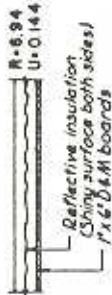

Average areas of ZONE 2 (Large or small barns)

SUGGESTED WALL SECTIONS

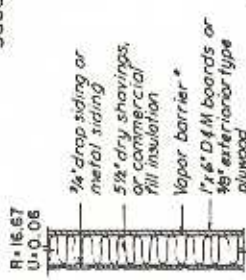

Cold areas of ZONE 1 (Large or small barns)



Cold areas of ZONE 1 (Large or small barns)



Average areas of ZONE 1 (Large or small barns)



Cold areas of ZONE 1 (Large barns)
Warm areas of ZONE 1 (Small barns)
Cold areas of ZONE 2 (Large, Small)

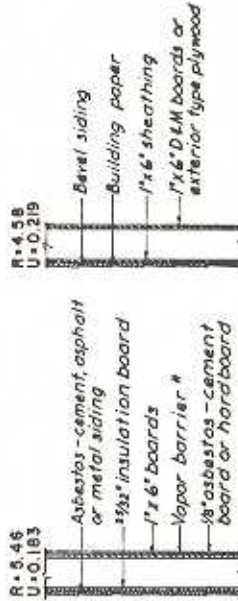

Warm areas of ZONE 1 (Large barns)
Average areas of ZONE 2 (Large barns)
Warm areas of ZONE 2 (Large, Small)

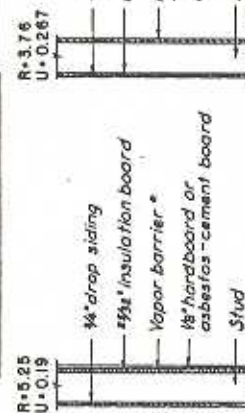

Warm areas of ZONE 2 (Large barns)



MAP SHOWING TEMPERATURE ZONES

* Vapor barriers shall be either shiny-surfaced building paper infused with asphalt or metal foil. When insulation board is used as inside finish, the vapor barrier shall be two coats of asphalt base aluminum-foils paint applied to the inside surface of the board.

NOTE: These wall and ceiling sections show types of construction suitable for the temperature zones shown on the map at right. In most cases the insulating value is minimum for the part of zone indicated.