

SECTION A-A

- CONSTRUCTION NOTES**
- 1. WIRE RUN PARTITIONS ARE 9'-18" LONG WHERE CONNECTED TO FRONT POLES IS REQUIRED IN 10'-10" PER UNIT.
 - 2. USE FRAMING ANCHORS, PULLERS OR STRAP, OR OTHER MEANS TO SECURE PARTITIONS AGAINST WIND UPLIFT.
 - 3. UTILITY ROOM SHOULD BE INSULATED AND HEATED. TYPE OF INSULATION AND LINING MATERIALS ARE LEFT TO BUILDER'S DISCRETION.

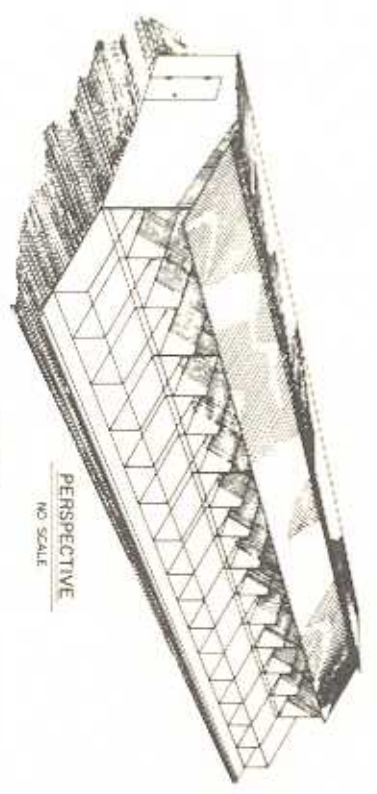

PERSPECTIVE
NO SCALE

NOTE:
CONSULT LOCAL HEALTH AND BUILDING CODE AUTHORITIES BEFORE STARTING CONSTRUCTION.

COOPERATIVE EXTENSION WORK IN AGRICULTURE AND HOME ECONOMICS

UNITED STATES DEPARTMENT OF AGRICULTURE COOPERATING

AND

**COLD CALF HOUSING
INDIVIDUAL CONFINEMENT**

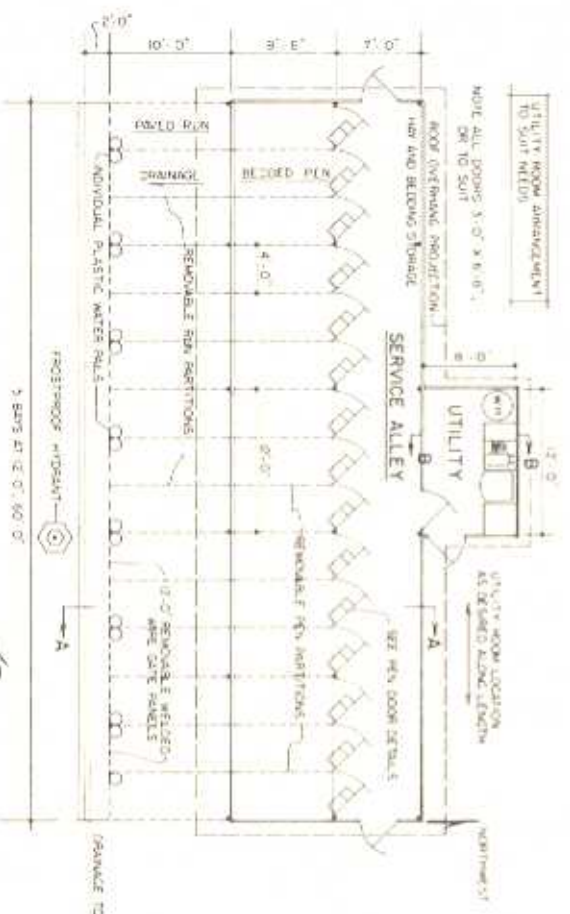

PLAN

