

AREA	NO. HEAD	STALLS *	AGE
9		CRATES	0-3 MONTHS (NOTE-1)
8	2'-0" x 4'-0"		4-5 MONTHS
6	2'-4" x 4'-6"		6-8 MONTHS
16	3'-0" x 5'-6"		9-16 MONTHS
18	3'-3" x 6'-0"		16-20 MONTHS
16	3'-6" x 6'-6"		21-24 MONTHS
19	3'-9" x 7'-0"		DRY COWS

PERSPECTIVE

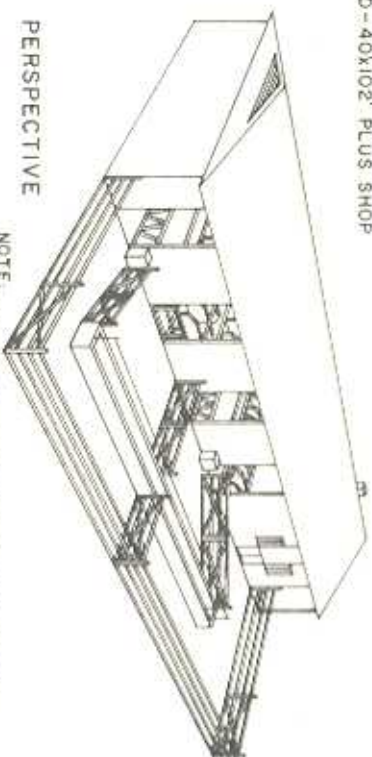

NOTE: CONSULT LOCAL HEALTH AND BUILDING CODE AUTHORITIES BEFORE STARTING CONSTRUCTION.

PLAN  
86 HEAD-40x102' PLUS SHOP

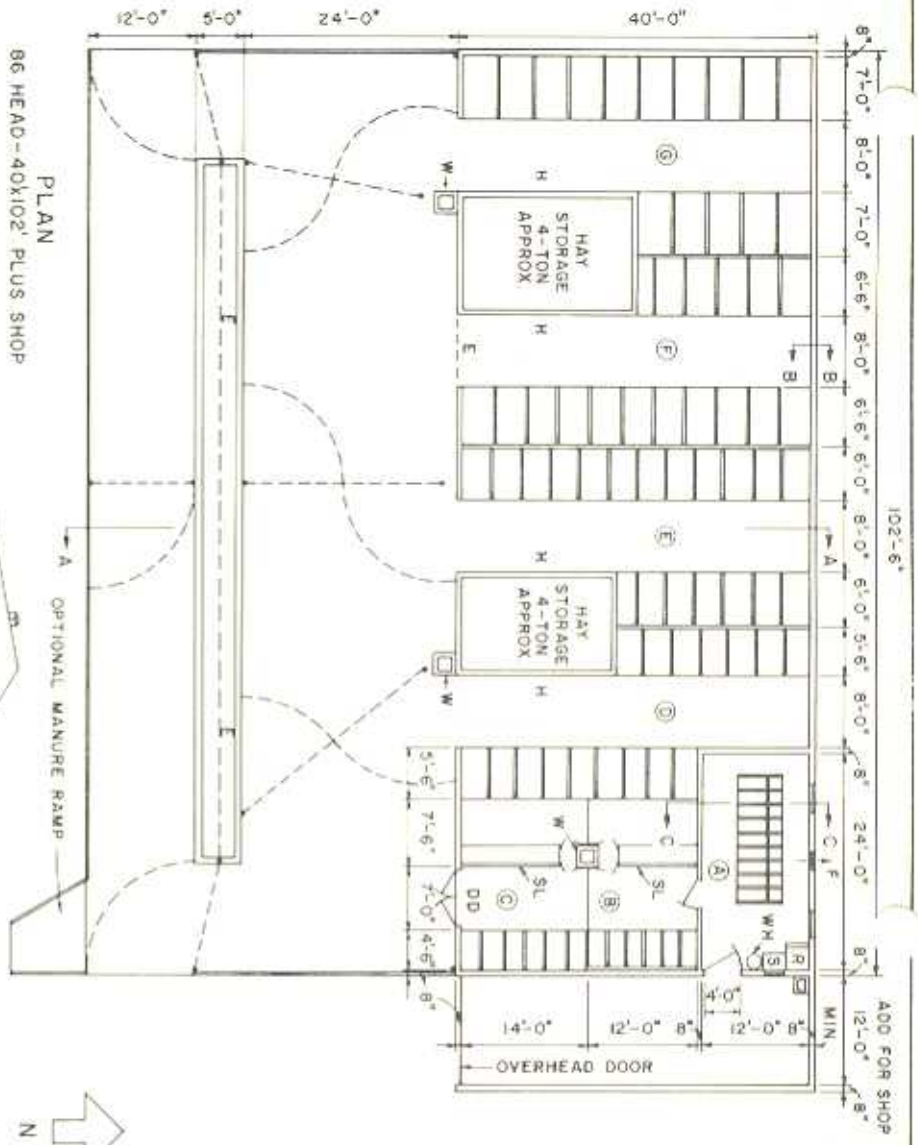

LEGEND

- 1 PROVIDE HEATING IN THIS AREA
- \* ADJUST STALL WIDTHS TO SPACE AVAILABLE
- \*\* ONE STALL MAY BE MADE WIDER FOR BULL
- W WATERER
- S SINK
- R REFRIGERATOR
- E ELECTRIC FENCE LINE
- H HAY FEEDERS
- SL CALF STANCHION LINE
- DD DUTCH DOOR (ALTERNATE-SLIDING DOORS SEE SHEET NO. 5)
- F FAN
- WH WATER HEATER (IF REQUIRED)

AREA	NO. HEAD	STALLS *	AGE
6	2'-0" x 4'-0"		0-3 MONTHS (NOTE-1)
6	2'-4" x 4'-6"		4-5 MONTHS
17	3'-0" x 5'-6"		6-8 MONTHS
17	3'-6" x 6'-6"		9-16 MONTHS
17	3'-8" x 6'-6"		17-23 MONTHS

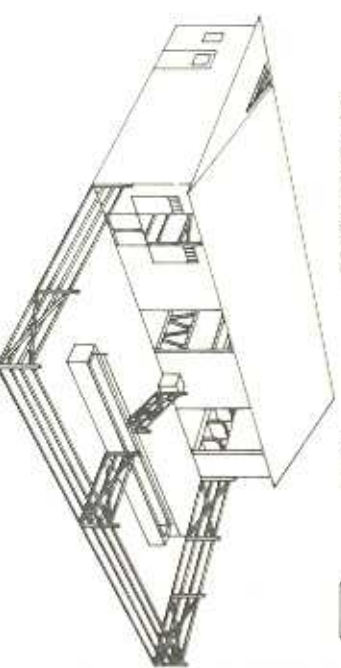

PLAN  
55 HEAD-40x60'

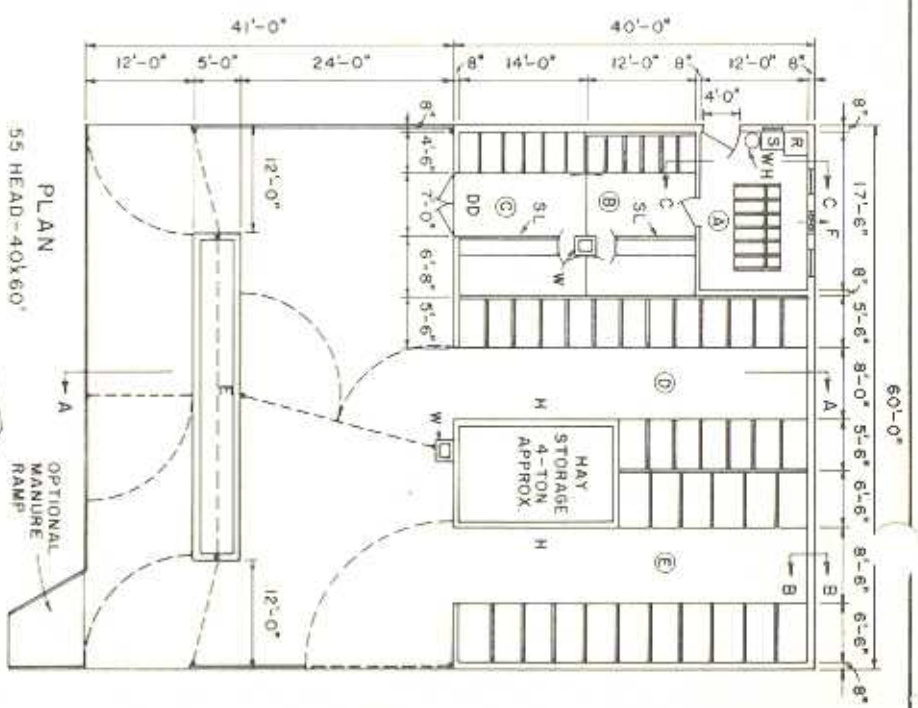

BASED ON: UNIV. OF MAINE PLAN NO. 36814, 15, 16, 17, 18, 20 & 21.  
COOPERATIVE EXTENSION WORK IN AGRICULTURE AND HOME ECONOMICS