

NOTE:

SET ALL POLES IN 18" DIA. HOLES AND TAMP BACKFILL THOROUGHLY. IN LOOSE OR SANDY SOIL, A CONCRETE FILL MAY BE REQUIRED.

CROSS SECTION



60'-0" LENGTH AS REQUIRED

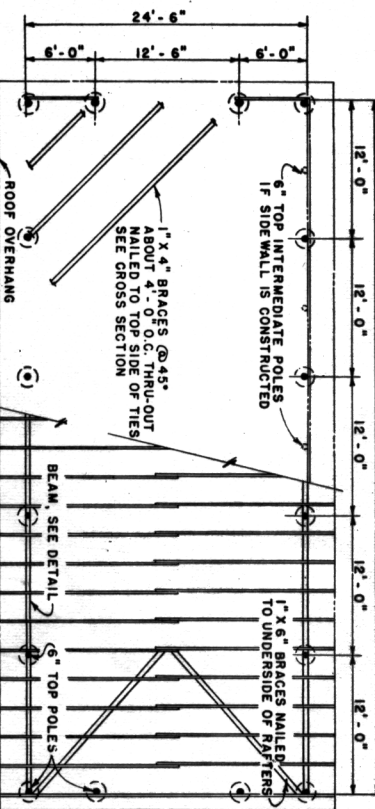

FLOOR AND ROOF FRAMING PLAN

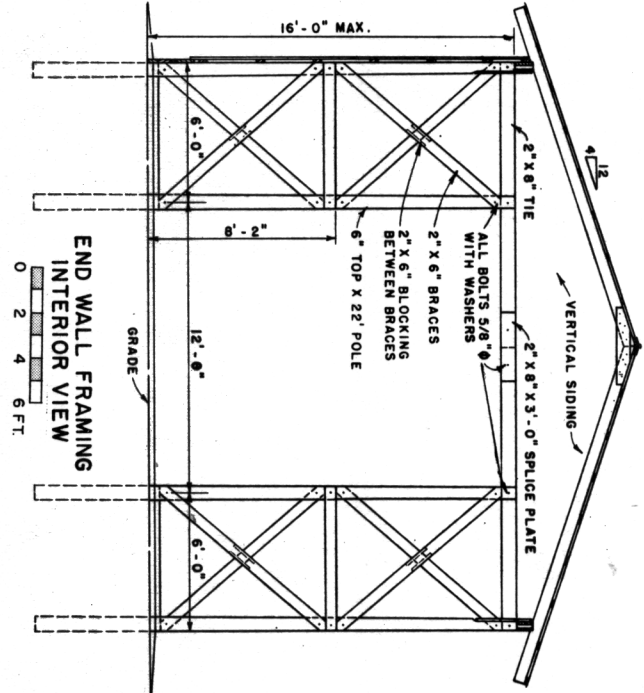

DETAIL OF GUSSET CONNECTION AT POLE

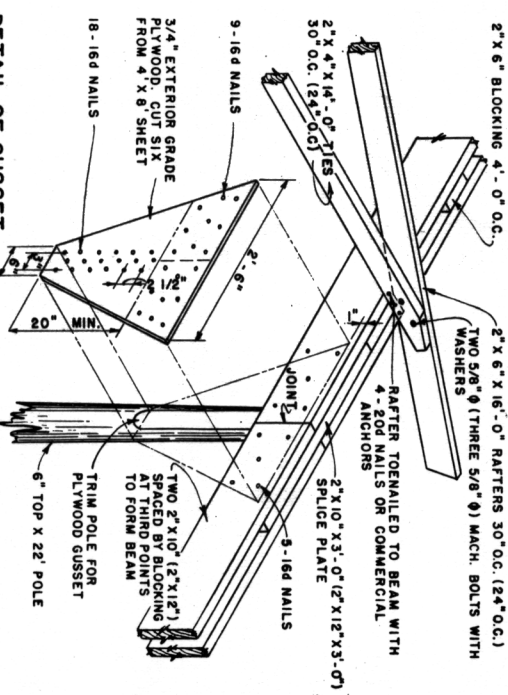

NOTE:
ALL POLES AND SPLASH BOARDS TO BE PRESSURE TREATED WITH
IN UNITS OF 2'-0" BUILDS DESIGNED FOR AREAS OF THE UNITED STATES
WHERE THE SNOW LOAD IS 20 LB. (OR SOL.) PER SQUARE FOOT OR WIND
30 LB. LOAD SHOWN IN PARENTHESES (---).