

VIEW OF COMPLETED TRUSS
NO SCALE

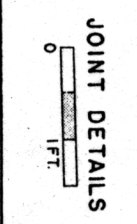
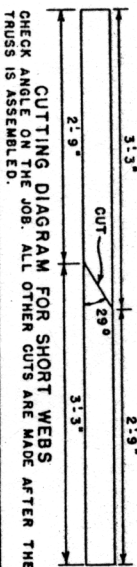
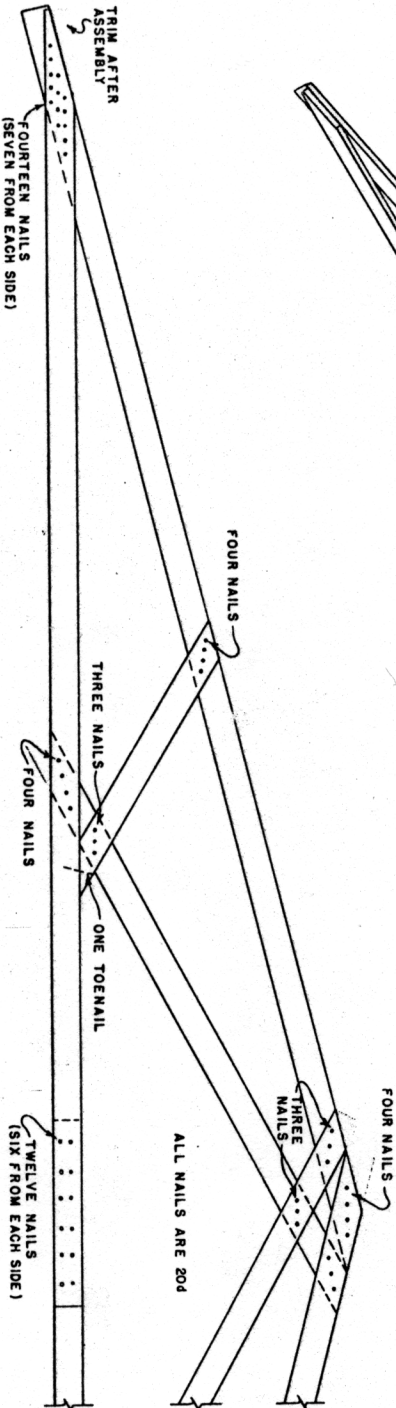

WHERE SNOW OR WIND LOADS WILL NOT EXCEED...	TRUSSES MAY BE SPACED UP TO...	ROOF SHEATHING
15 LBS. PER SQ. FT.	4'-0" O.C.	2'-4" Laid Flat Spaced 3'-6" O.C. FOR 2 1/2" COR. METAL ROOFING ONLY
20 " " " "	2'-8" " "	1" NOMINAL SOLID WOOD SHEATHING FOR ALL ROOFING MATERIALS
25 " " " "	2'-4" " "	
30 " " " "	2'-0" " "	

THIS TRUSS IS DESIGNED TO SUPPORT LOADS UP TO 10 LBS. PER FOOT OF SPAN, INCLUDING THE WEIGHT OF THE ROOF.

ALL LUMBER SHALL BE STRESS GRADED LUMBER AND SHALL BE FIBER STRESS IN BENDING, AND 1350 PSI IN COMPRESSION.

MATERIALS FOR ONE TRUSS:

TOP CHORD.....2 PCS. 2x4x14x16'-0"

BOTTOM CHORD.....2 " " 2x4x14x16'-0"

LONG WEBS.....1 " " 2x4x14x16'-0"

SHORT WEBS.....1 " " 2x4x14x16'-0"

NAILS.....2 1/2 LBS. 20d COMMON

ALL PROJECTING NAILS ARE TO BE CLINCHED.

TRUSSES SHOULD BE SECURELY ANCHORED TO THE SUPPORTING STRUCTURE.